

The installation, maintenance, or removal of an antenna requires qualified, experienced personnel. You must refer to the appropriate local safety codes and ensure proper electrical and electromagnetic compatibility before proceeding with the installation. All local codes shall take precedence over information in this document. Antenna systems should be inspected once a year by qualified personnel to verify proper installation, maintenance, and condition of equipment. Communication Components Antennas Inc. disclaims any liability or responsibility for the results of improper or unsafe installation.

Fig. 1: Exploded View with Part Numbers and BOM

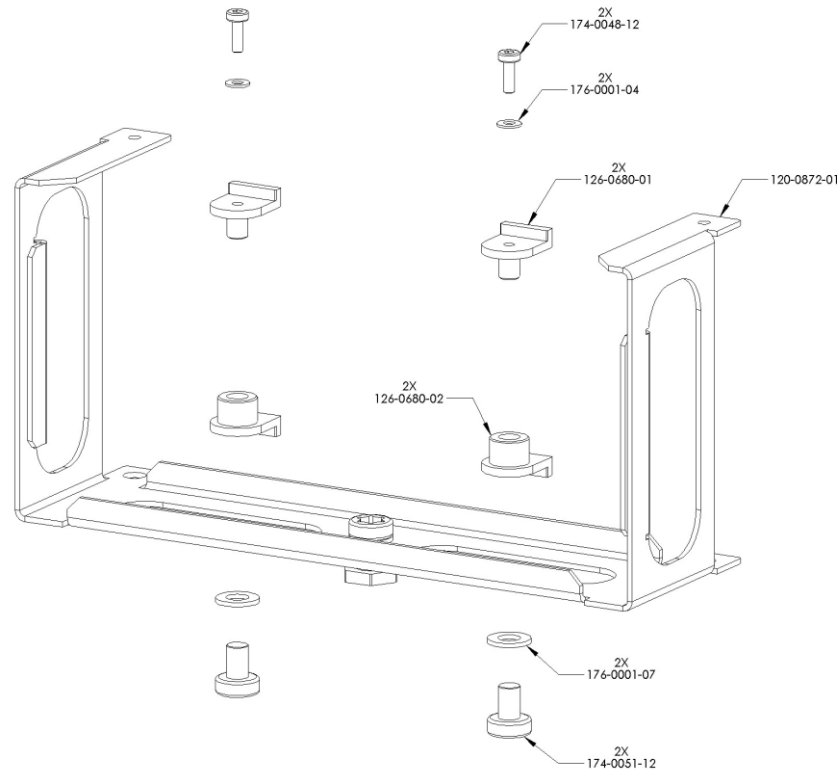

ITEM	QTY	DESCRIPTION
120-0872-01	1	BRACKET
126-0680-01	2	SPACER (SMALL BOSS)
126-0680-02	2	SPACER (LARGE BOSS)
174-0048-12	2	TORX PAN HEAD, M4X0.70, 12MM
174-0051-12	2	TORX PAN HEAD, M8X1.25, 12MM
176-0001-04	2	FLAT WASHER, M4
176-0001-07	2	FLAT WASHER, M8

Fig. 2: Exploded View Showing Spacer Positions and Orientation

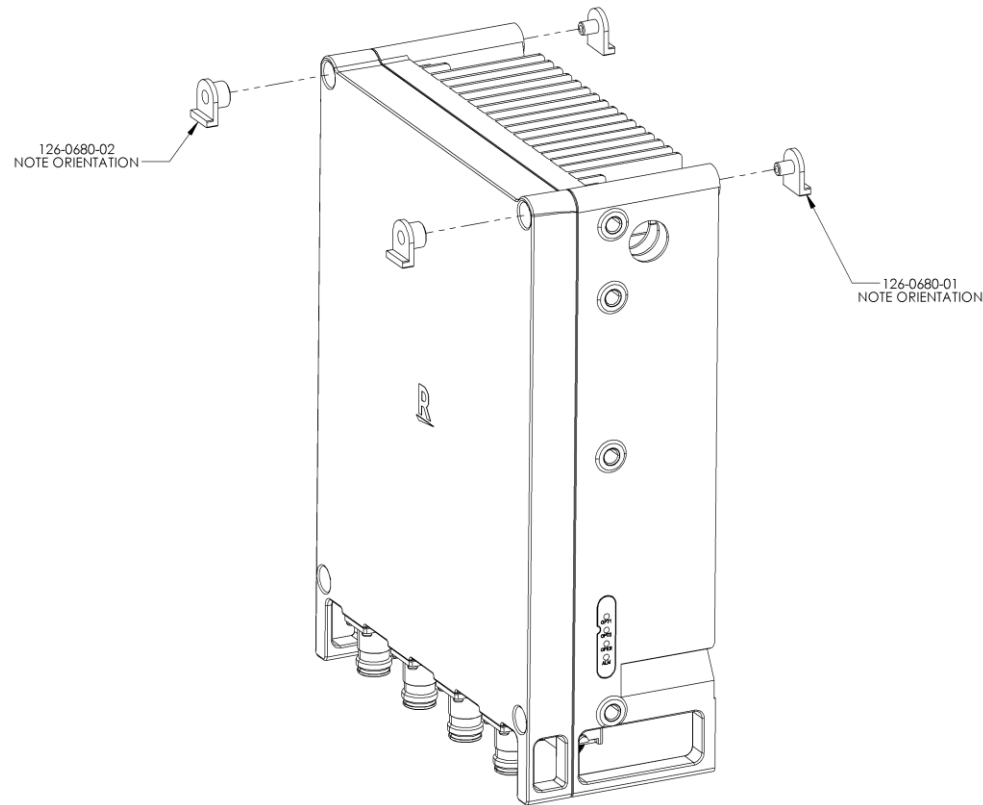

Step	Task
------	------

- | | |
|---|---|
| 1 | Orient the radio with the handle and connector side down on a surface. Place two spacers (126-0680-01) in the two top holes on the heatsink side of the radio. Place the other two spacers (126-0680-02) in the top two holes on the opposite side of the radio. Flat tabs on all 4 spacers should be downward, pointing to the connectors. |
|---|---|

Fig. 3: Exploded View Showing Placement of Handle Bracket

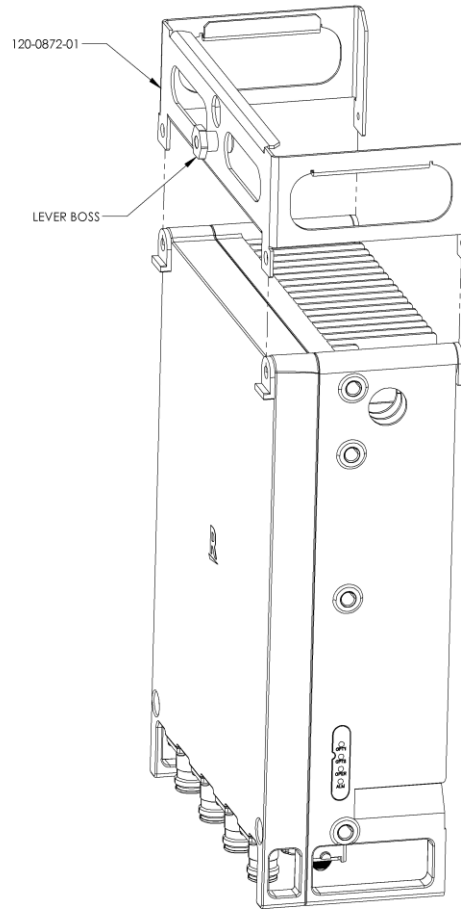

Step	Task
------	------

- | | |
|---|---|
| 2 | Slide bracket (120-0872-01) over the spacers placed in step 1. Note orientation with the lever boss on the side opposite of the heatsink. |
|---|---|

Fig. 4: Exploded View Showing Screw Locations and Torque Values

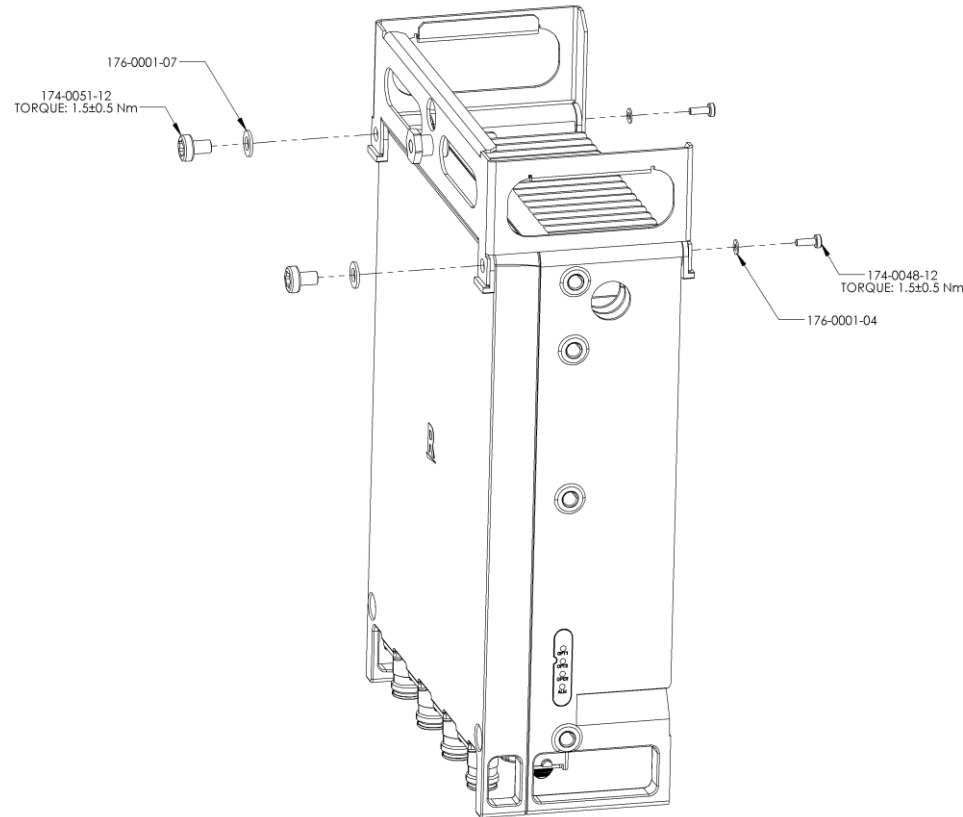

Step	Task
------	------

- | | |
|---|---|
| 3 | Place the two M4 screws (174-0048-12), through the M4 flat washers (176-0001-04) and bracket (120-0872-01) on the top side with the heatsink. Torque the two M4 screws (174-0048-12) into spacers (126-0680-01) to 1.5 ± 0.5 Nm.
Place the two M8 screws (174-0051-12), through the M8 flat washers (176-0001-07) and bracket (120-0872-01) on the opposite side of the heatsink. Torque the two M8 screws (174-0051-12) into spacers (126-0680-02) to 1.5 ± 0.5 Nm. |
|---|---|