

## DISCLAIMER:

The installation, maintenance, or removal of an antenna requires qualified, experienced personnel. You must refer to the appropriate local safety codes and ensure proper electrical and electromagnetic compatibility before proceeding with the installation. All local codes shall take precedence over information in this document. Antenna systems should be inspected once a year by qualified personnel to verify proper installation, maintenance, and condition of equipment. Communication Components Antennas Inc. disclaims any liability or responsibility for the results of improper or unsafe installation.

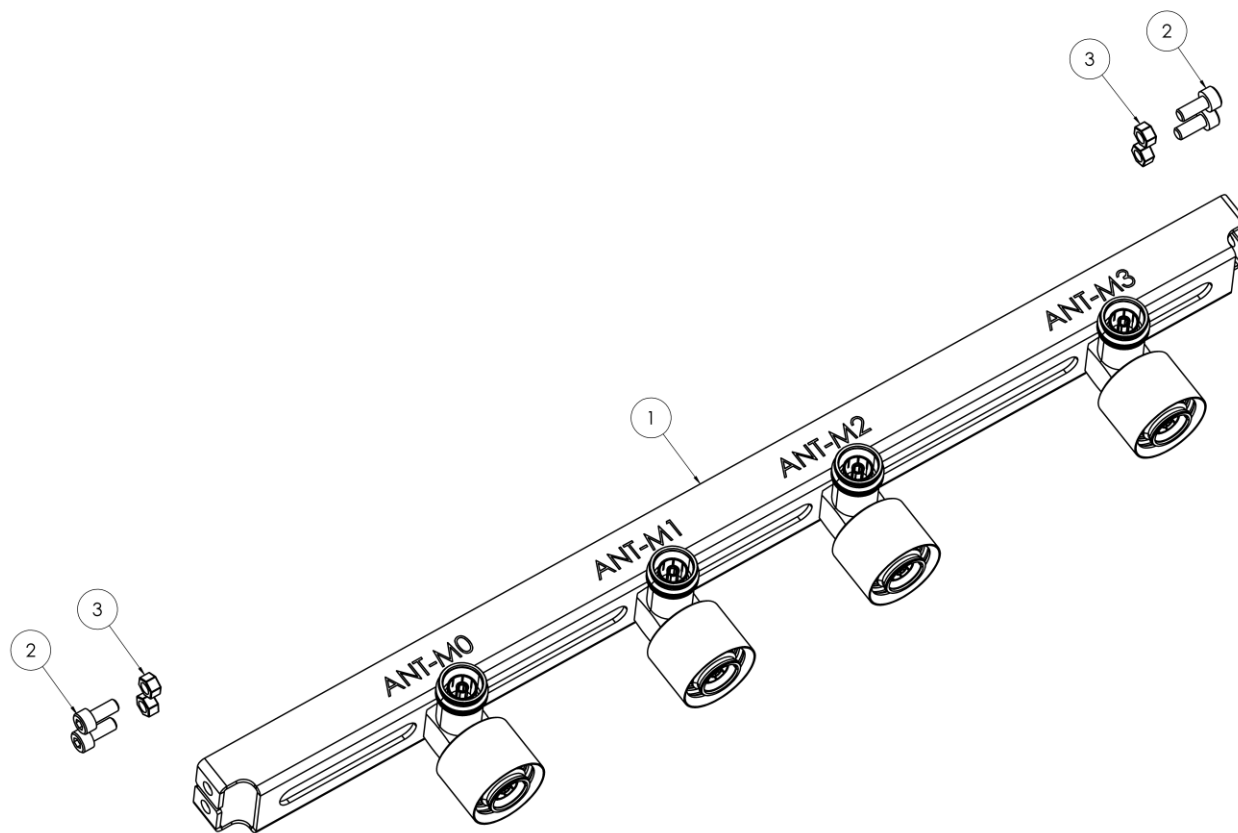

Fig. 1: Remote Radio Kit BOM

ITEM	QTY	DESCRIPTION
1	1	SUBASSEMBLY, CONNECTOR BRACKET
2	4	SCREW, SHCS, M5, 12MM
3	4	HEX NUT, M5

# Installation Guide for Remote Radio Installs CV-01

Fig. 2: Initial Connector Subassembly Placement on Antenna

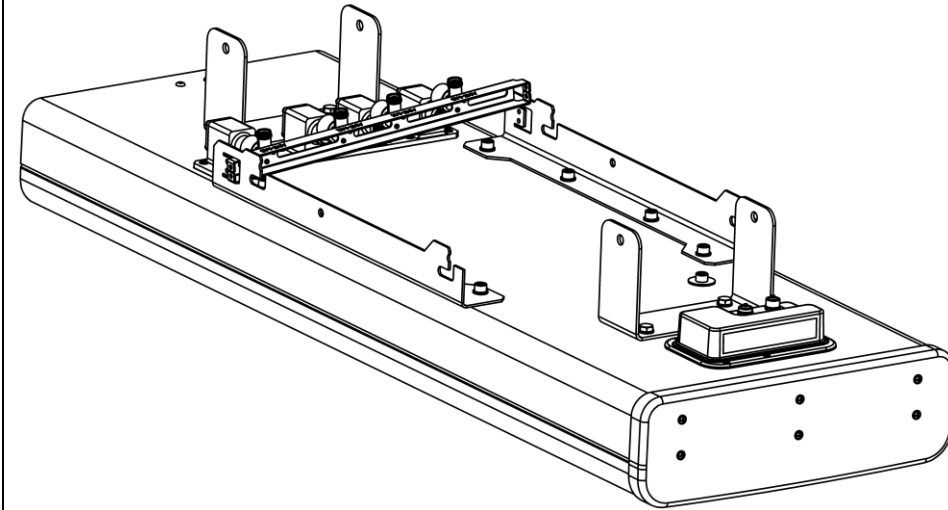

Fig. 3: Final Connector Subassembly Placement on Antenna

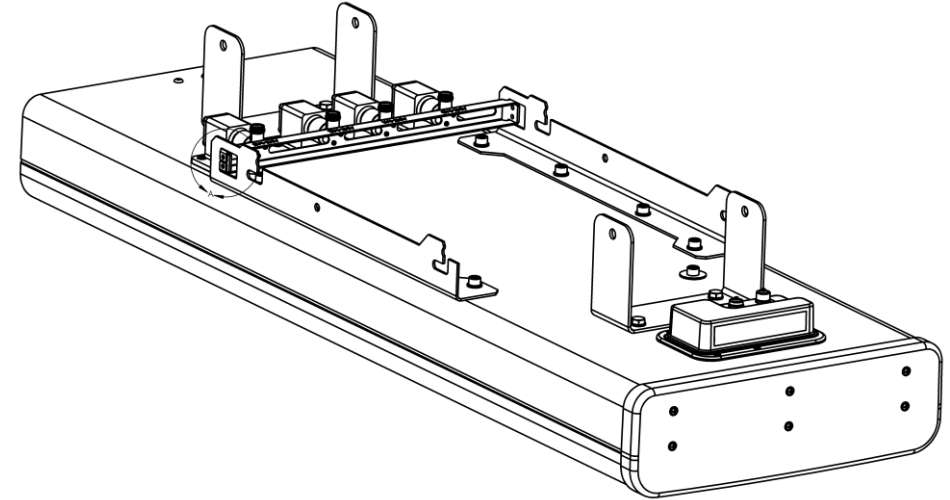
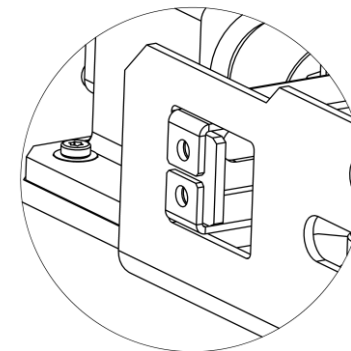

Fig. 4: Positioning Detail View (Detail A)



Step	Task
1	Tilt connector subassembly (Item 1) to engage 1 side, seen in Figure 2. Shift connector bracket towards the engaged side. Remove tilt by making connector subassembly parallel to antenna. Shift bracket back to center, in between side rails. All 4 tabs of the connector subassembly should now be able to slide outside of the tabs on the rails seen in figure 4. Press bracket towards connector housing which is seen in Figure 3.

Fig. 5: SHC Screw and Nut Location Overall View

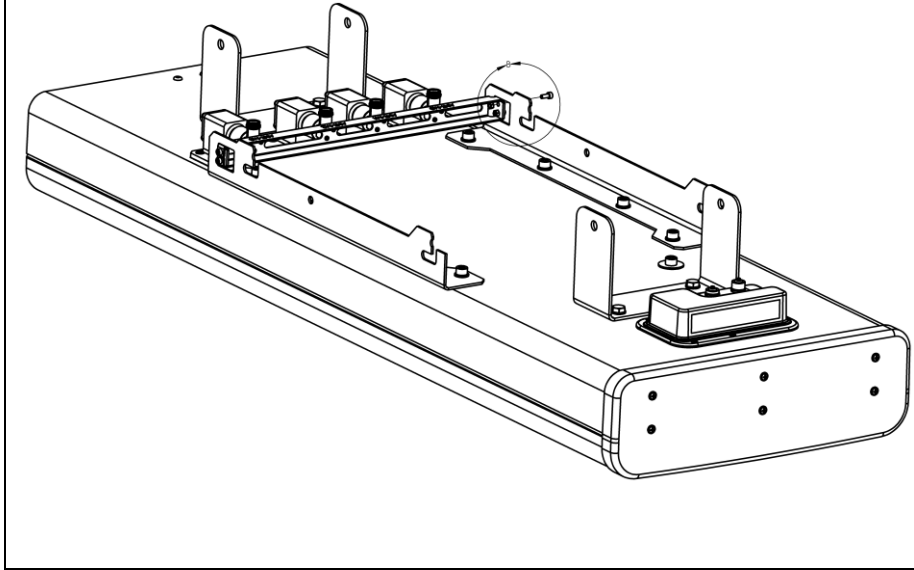
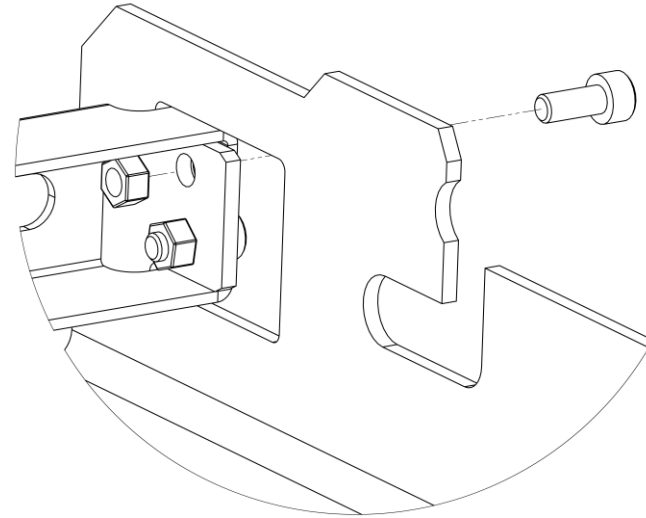

Fig. 6: SHC Screw and Nut Location Detail View (Detail B)



Step	Task
------	------

- |   |   |
|---|---|
| 2 | While pressing on the bracket, engage all 4 SHC screws (Item 2) when the bracket holes line up. The internal connectors are spring loaded and CV-01 will be fully seated at this stage. Add M5 screw (Item 2) and hex nut (Item 3) on opposite side and torque to $5.0 \pm 0.5$ N·m ( $44.5 \pm 4.5$ in-lbs) seen in Figure 5 & Figure 6. |
|---|---|

Fig. 7: View of Port Labels on CV-01 Installed on Antenna

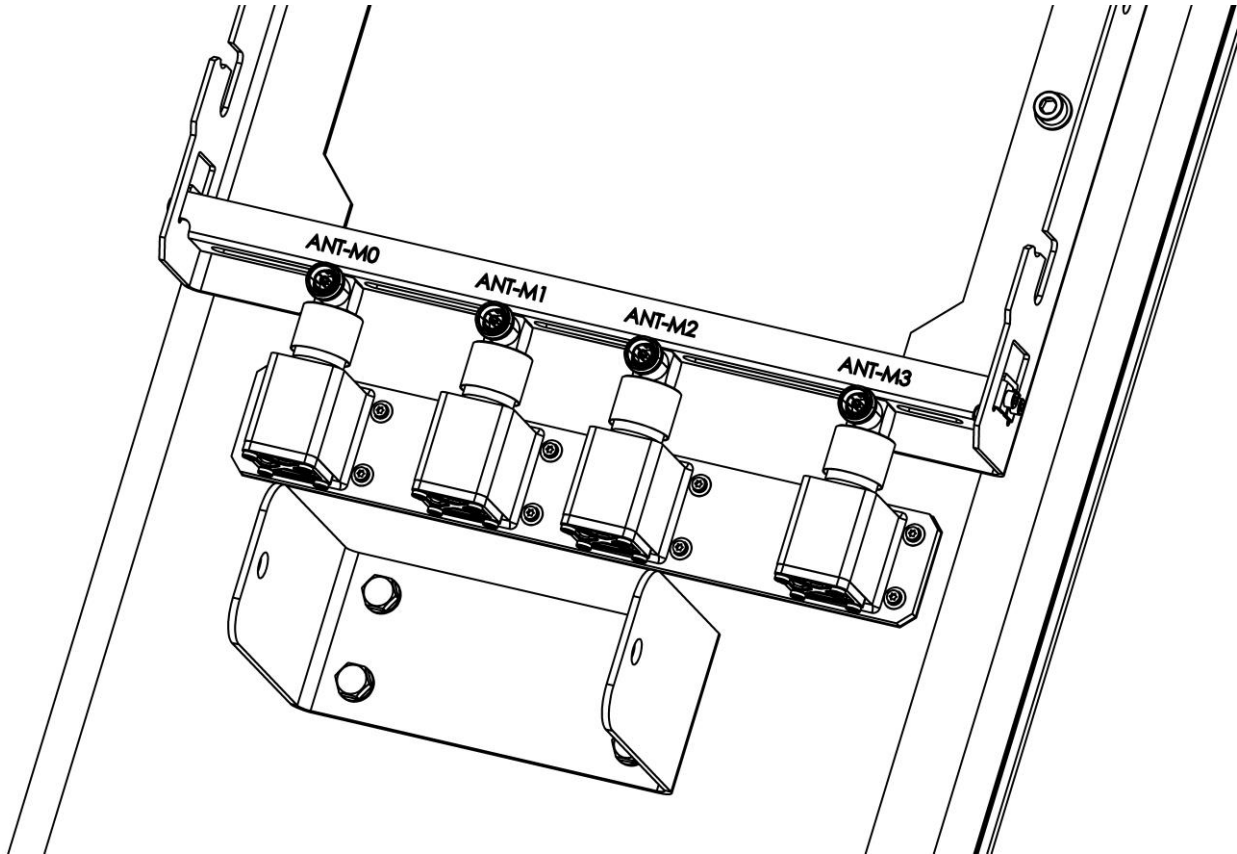

Step	Task
------	------

3	See Fig. 7 for a view of the port labels on CV-01 installed on the antenna.
---	---

Note	To remove the CV-01, the process is the reverse of the installation steps.
------	--